

# Tumble dryer

## T3900, T31200

### Features and benefits

- High productivity - 2 full loads per hour
- Selection of temperature and time for easy operation
- Large door opening for easy loading and unloading
- Only one external connection for electricity, utility and exhaust for simple installation
- Large selfcleaning lint screen for easy maintenance
- Easy access to vital parts from front and rear for simple servicing
- Selecta microprocessor control
- Reversing drum
- Emergency stop
- Supply disconnecter
- Gas reset from front (gas version)

### Main options

- Stainless steel front and/or side and top
- Stainless steel drum
- Frequency controlled motor
- Fresh air intake
- Indicator lamp for finished drying cycle
- RMC (Residual Moisture Control)
- Sliding door (separate data sheet)
- Tilting forward (separate data sheet)



Main specifications		T3900				T31200			
Rated capacity	kg/lb	45/100				60/132			
Drum volume	litre	900				1200			
Drum diameter	mm	1240				1240			
Heating alternatives									
gas	BTU/h (kW)	218 430 (64)				279 865 (82)			
steam at 8 Bar	kW	82				72			
el	kW	48/60				60/72			
<b>Consumption data*</b>		Gas	Steam	EI 48 kW	EI 60 kW	Gas	Steam	EI 60 kW**	EI 72 kW**
Total time full load	min	26	31	35	28	27	31	35	26
Energy consumption full load	kWh	26.2	43.5	27.4	28	35.6	38.3	34.8	30.8
Evaporation	g/min	865	735	651	803	1070	950	854	923
Energy kWh/litre water evaporated	kWh	1.16	1.91	1.2	1.2	1.23	1.3	1.17	1.28
* At rated capacity 100% cotton load at 50% initial moisture dried to 0%.									
** Capacity 48 kg/100 lbs.									

Certified in accordance with ISO 9001 and ISO 14001 and approved IP 42.

Electrical connections			T3900	T31200
Heating Voltage				
EI	230-240V 3 AC 50/60 Hz	kW(A)	51 (160)	-
	400-415V 3 AC 50 Hz	kW(A)	51 (80)	63 (100)
	400-480V 3 AC 60 Hz	kW(A)	51 (80)	63 (100)
	400-415V 3 AC 50 Hz	kW(A)	63 (100)	75 (125)
Gas or steam	400-480V 3 AC 60 Hz	kW(A)	63 (100)	75 (125)
	200-240V 3 AC 50/60 Hz	kW(A)	3.3 (20)	3.3 (20)
	400-415V 3 AC 50 Hz	kW(A)	3.3 (16)	3.3 (16)
400-480V 3 AC 60 Hz	kW(A)	3.3 (16)	3.3 (16)	
Steam, gas and air connections				
Steam	ISO 228/1-G1		1"	1"
Steam pressure		kPa	100-1000	100-1000
Steam consumption		kg/h	143	143
Condensate	ISO 228/1-G1		1"	1"
Gas	ISO 7/1-Rp		1"	1"
Gas pressure	Natural gas	Pa	2000	2000
		mbar	20	20
		Propane	Pa	2800-5000
		mbar	28-50	28-50
Air outlet		mm	Ø 315	Ø 315
Evacuated air,	steam		2300	3000
	gas		2300	3000
Pressure drop		Max. Pa	100	100
Sound levels				
Airborne sound level		dB(A)	<70	<70
Heat emission				
% of installed power, max			15	15
Shipping data				
Heating unit, gas/steam/electric		net, kg	39/50/42	46/50/42
		total net, kg	480	550
Dimensions in mm				
A	Width		1290	1290
B	Depth		1295	1485
C	Height		2465	2465
D	(with top removed)		1965	1965
E			780	780
F			850	850
G			245	245
H			230	230
I			1590	1590
K			120	120
L			180	180
M			2055	2055
N			410	410
O			2025	2025
P			2360	2360
R			570	570
S			2400	2590
T			1810	1810
1	Control panel	5	Steam connection	
2	Door opening Ø 940	6	Condensate connection	
3	Electrical connection	7	Exhaust connection	
4	Gas connection	8	Delivery height	

\* Other voltages available see installation manual.

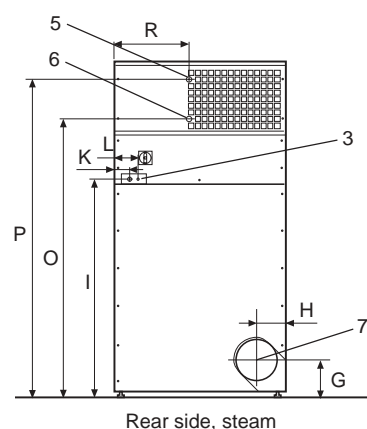
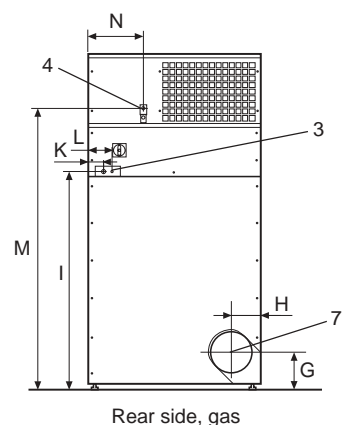
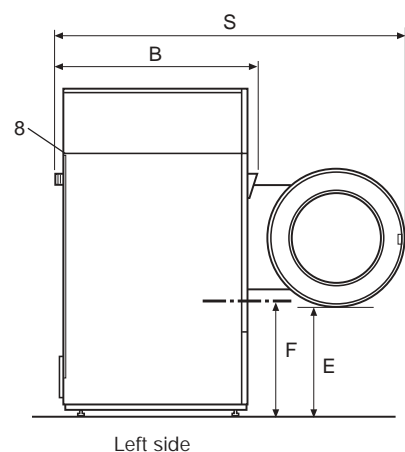
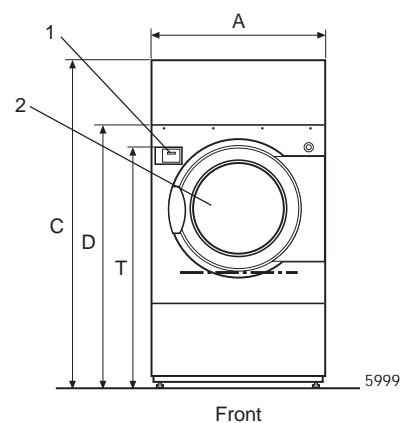

**Electrolux**

ELECTROLUX LAUNDRY SYSTEMS

Lundtoftegaardsvej 93A, DK-2800 Lyngby, Denmark  
 Telephone: +45 4526 4800. Telefax: +45 4526 4801  
 Internet: www.electrolux.com/laundrysystems  
 E-mail: els@electrolux.dk

**The Electrolux Group.** The world's No.1 choice.

The Electrolux Group is the world's largest producer of powered appliances for kitchen, cleaning and outdoor use. More than 55 million Electrolux Group products (such as refrigerators, cookers, washing machines, vacuum cleaners, chain saws and lawn mowers) are sold each year to a value of approx. USD 14 billion in more than 150 countries around the world.

Art. No. 438918491/07 04.02  
 We reserve the right to alter specifications without notice.